

*Congratulations on your purchase of a DOWCO manufactured mooring/trailerable boat cover. Your cover is designed to properly fit your boat and protect it from the environment using the highest quality materials available for marine applications.*

**Installation Instructions:**

Please read the following information before you assemble your new cover to your boat for the first time.

**A. Positioning the boat cover**

1. Position the cover at the bow of the boat and pull it from the bow to the stern. It should fully cover the boat with enough material to hang evenly around the full perimeter of the boat.

** WARNING**

If you have a boat with a high acrylic windshield you may have to remove it before installing your cover. Check the tag in the front of your cover to determine if your windshield must be removed. Failure to do so may result in damage to windshield, cover, and/or boat while trailering.

2. Some models utilize the fishing seats to hold the cover up as high as possible. If your cover appears to be hanging too low around the sides, insert the seat in the appropriate area to raise the cover.
3. There are a few models that are equipped with adjustable poles. These will also reduce the chance of water pockets forming. If equipped, extend the poles as high as possible to create proper runoff. The pole may be adjusted by pushing the spring button and moving the upper section either up or down to obtain the best fit. If you are provided with a pole that is approximately 28 ½" long, before extension, you may be able to change the total extended height by removing the cap, pulling the sections apart, then reassembling by flipping the inner section. If, after putting the button to it's lowest position, your pole is still too long, it may be necessary to remove the plastic cap, cut the pole to a suitable length, and reassemble.

** CAUTION**

Adjustable poles must be removed prior to trailering. These are to be used for mooring/storage only. Failure to remove poles prior to trailering may result in damage to the boat and/or cover.

4. Your cover is equipped with patches in areas that have obvious sharp edges/wear points. Please take the time to look for other points of abrasion, adding additional protective padding as needed. Foam or soft cloth will help to reduce the possibility of damage.

**B. Securing the boat cover**

1. After the cover has been positioned, loosely attach the web straps provided. Depending on your boat type, there may be several lengths of web straps included. Separate each different length into groups. The longer web straps are fitted from the bow with shorter straps toward the stern.

2. Assembling the tri-glide buckles, (see diagram next page)

**For straps not located over wheel of trailer:**

- a. String web strap through tri-glide buckle.
- b. Pull web strap down around trailer frame.
- c. Pull strap upwards. String through side release buckles.

**For straps located over wheel of trailer (available only on select models):**

- a. String web strap through tri-glide buckle.
- b. Slide snap hook onto web strap.
- c. String web strap through side release buckle.

**⚠ WARNING**

**DO NOT** string web through trailer frame. Failure to follow these instructions may result in the web straps becoming entangled in the moving wheels, causing damage to the boat or cover.

*If your cover is supplied with several snap hooks, follow steps d & e, otherwise go to step 3.*

- d. Install eye loop on trailer directly below snap hook. Mark trailer for drilling. Drill hole for screw using a 5/32" drill bit. Attach eye loop with machine screw, washer and locknut.
- e. Snap hook onto eye loop located over wheel of trailer. Pull end of web strap to tighten. If you find that the straps are too long, we recommend cutting excess off with a scissors.

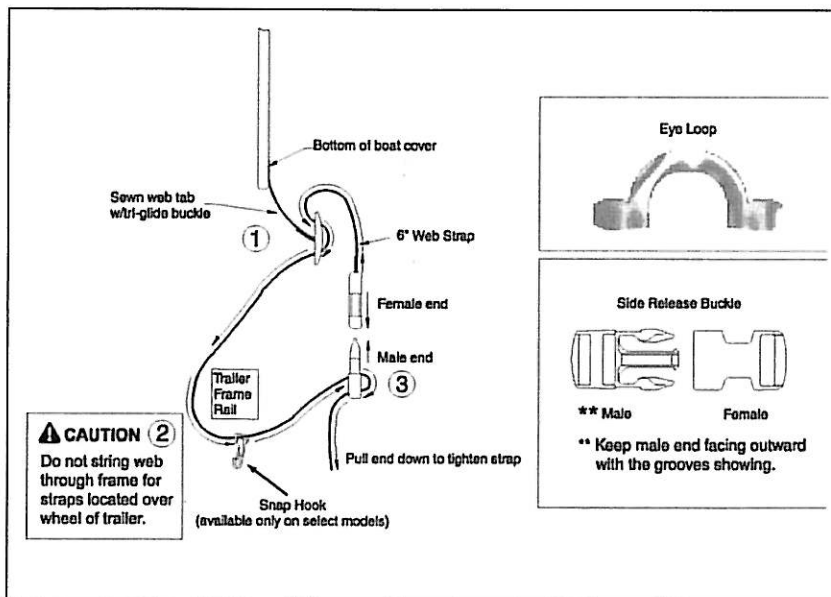

3. Additional tie-off loops on the cover (one at the bow, two at the stern) are also provided on some models. These may be used with the addition of a tie-off rope (not supplied).
4. Your cover is also supplied with a rope in the hem. After the cover has been properly positioned, pull the rope tight and tie off in an "X" pattern at the stern. The port side rope should be tied off on the starboard and the starboard rope tied off on the port side. This will keep the cover tight against the motor area and prevent it from wind buffeting.
5. Tightly pull the straps and cut off any excess with a knife or scissors leaving a maximum of 6". To prevent the cut edge from fraying, singe it with a hot knife, soldering iron, lighter or candle.

 **CAUTION**

When trailering, use all the tie-down straps to secure the cover. Also, make sure that all web straps are properly trimmed to prevent them from entangling in moving wheels or rubbing against the finish of the boat. Failure to follow the above information may result in damage to the cover or boat.

### **C. Care and Cleaning**

1. Clean with mild soap and water to remove dirt, bird droppings and tree sap.
2. Dry cover prior to storage. Never store the cover wet as mold/mildew may develop, causing damage to the cover.
3. Prevent sharp objects, solvents, and hot items from coming into contact with the cover.
4. If stored outdoors, do not allow ice or water to accumulate as this may damage the cover. For more information see step **A. Positioning the boat cover**, for ways to reduce or eliminate water accumulation.
5. Although your cover is treated with UV inhibitors, some sun fading may occur. This is a natural process and is not covered by our limited warranty.